



*to do the  
greatest good*

The Campaign for  
Cornell University

Cornell **CALS** College of Agriculture  
and Life Sciences

# PLANT SCIENCE BUILDING RENOVATION

A high-performance space for research & education



The College of Agriculture and Life Sciences' Plant Science building is the home to our world-renowned **School of Integrative Plant Science**, known as SIPS, and is the largest building on the Ag Quad.

Despite its key importance to our students and faculty, much of the Plant Science building has not been renovated since the building's original construction in the 1920s. We are set to begin work in 2022 on the first phase of a \$100m+ remodeling project to update the Plant Science building.



**Rendering for new entryway to the building's "heart" lobby.**

Renovations to the plant science building will help SIPS and CALS:

- Support cutting-edge research and education
- Attract and retain the best faculty and students
- Enhance multidisciplinary research
- Foster collaboration



*to do the  
greatest good*  
The Campaign for  
Cornell University

Cornell **CALS** College of Agriculture  
and Life Sciences

## The School of Integrative Plant Science

CALS is a global leader in plant science, and SIPS is an area of CALS that creates unique and distinctive cross-college, university-wide opportunities. We are:

- 850 people: faculty, staff, and students—the largest unit in CALS
- 106 faculty
- \$30M annual research revenue

Our research and teaching are focused on:

- Food security
- Biodiversity
- Environmental conservation
- Indoor food production
- Digital agriculture
- Climate change
- Health and nutrition



## Our 2022 strategic plan Grand Challenges

- Sustainable crop production & food security
- Plants & ecosystem/climate health
- Plants & ecosystem services in the urban environment
- Evolution, biodiversity, & molecular mechanisms



*to do the greatest good*

The Campaign for Cornell University

Cornell **CALS**

College of Agriculture and Life Sciences

# Donor Opportunities

*Gifts can be payable over 5 years*

## SPACE

## MINIMUM NAMING AMOUNT

Lab Wings	\$1,000,000
“Heart” Lobby & Event Space	\$750,000
Teaching Laboratory	\$500,000
Living/Learning Courtyards	\$400,000
Meeting Rooms	\$150,000 - \$400,000
Classrooms	\$250,000
SIPS/Mann Library Breezeway	\$250,000
Lounges	\$100,000
Collaboration Areas	\$75,000

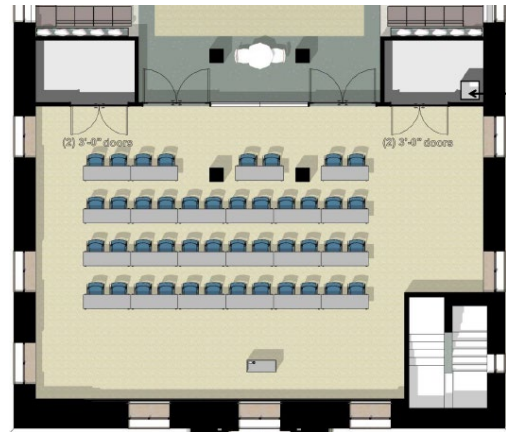

**Classroom layout**



**Collaboration Hub**

**“Heart” lobby leading to event space**





*to do the  
greatest good*  
The Campaign for  
Cornell University

## Research Wings

Each research wing is designed with strategic adjacencies for related research disciplines, flexible labs, and shared resources.

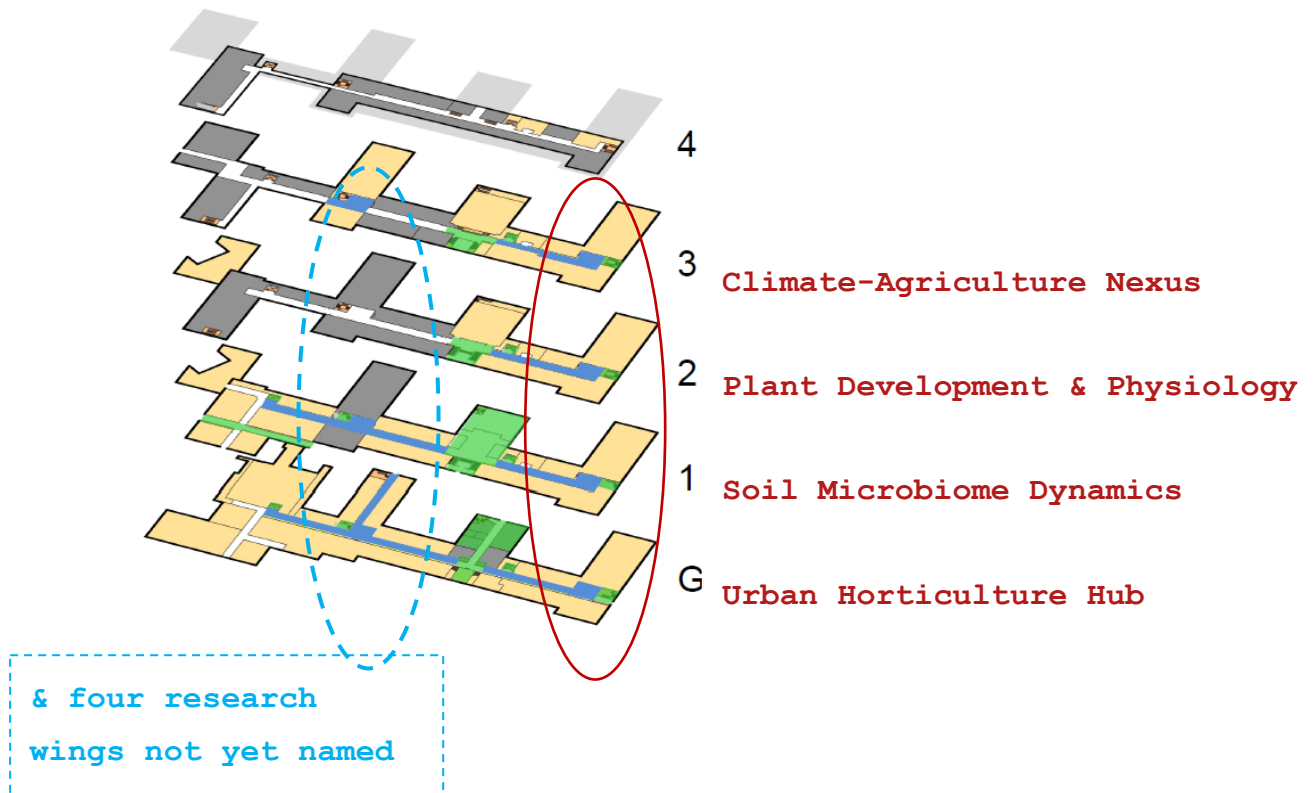

As of 4/26/2022